

DIGITAL COUNTER

1911

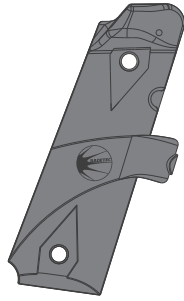

PACKAGE CONTENTS

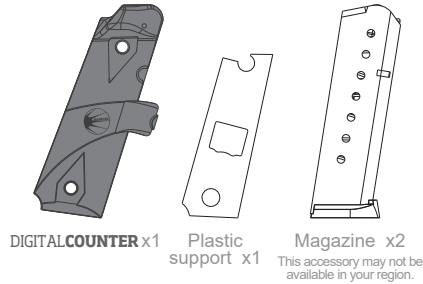

TOOLS

*not included



ASSEMBLY · GUN

Disassemble the original grips

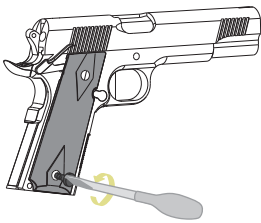

Assemble the battery(LeftGrip)

Low battery: A point in Display Indicator.

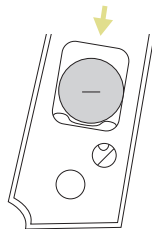

Assemble plastic support

Put the plastic support between the gun and the left grip.

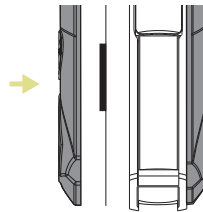

Assemble DIGITAL.COUNTER grips using original screws & washers

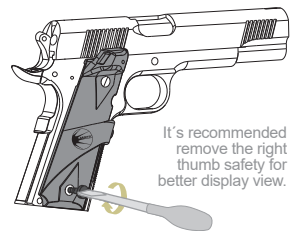

WARNING

Always make sure your firearm is unloaded, no rounds in the chamber and pointed in a safe direction before you disassemble and work on it.

WARNING

This device DOES NOT count rounds in the chamber and DOES NOT show if there is a round in the chamber. Always make sure your firearm is unloaded and with no round in the chamber.

ASSEMBLY · MAGAZINE Use only ACT-MAG original magazines.

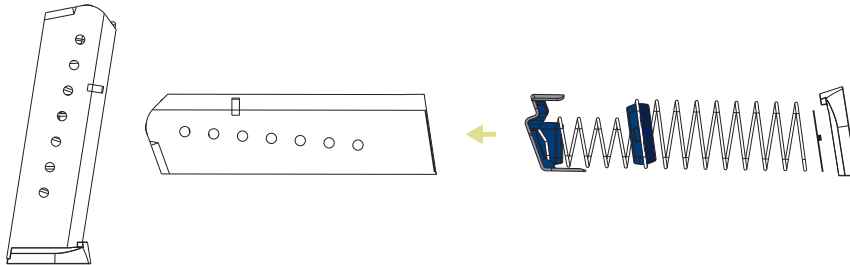

Position of the blue parts on the spring.

Don't remove blue parts. They are necessary for correct device operation.

MAGAZINE CALIBRATION Use only ACT-MAG original magazines.

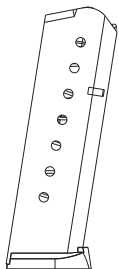

CALIBRATION IS ONLY REQUIRED IF COUNT SEQUENCE IS INCORRECT.

1. ENTERING CALIBRATION MODE

Push total shot counter button (left) and reset button (inside grip).

2. MAGAZINE

Load 7 cartridges in the magazine.

3. GUN

Load a cartridge in the chamber.

4. FIRE THE GUN

Shoot holding check button, keeping an interval of 2 seconds between shots.

5. EXITING CALIBRATION MODE

- Automatically after last shot.
- After 15 seconds timeout counting from step 1.
- By pressing counter button until display shows 0.

KNOW YOUR DIGITAL COUNTER

WARNING

Always make sure your firearm is unloaded, no rounds in the chamber and pointed in a safe direction before you disassemble and work on it.

TOTAL SHOT COUNTER
BUTTON (LEFT)

DISPLAY INDICATOR

RESET BUTTON
(INSIDE GRIP)

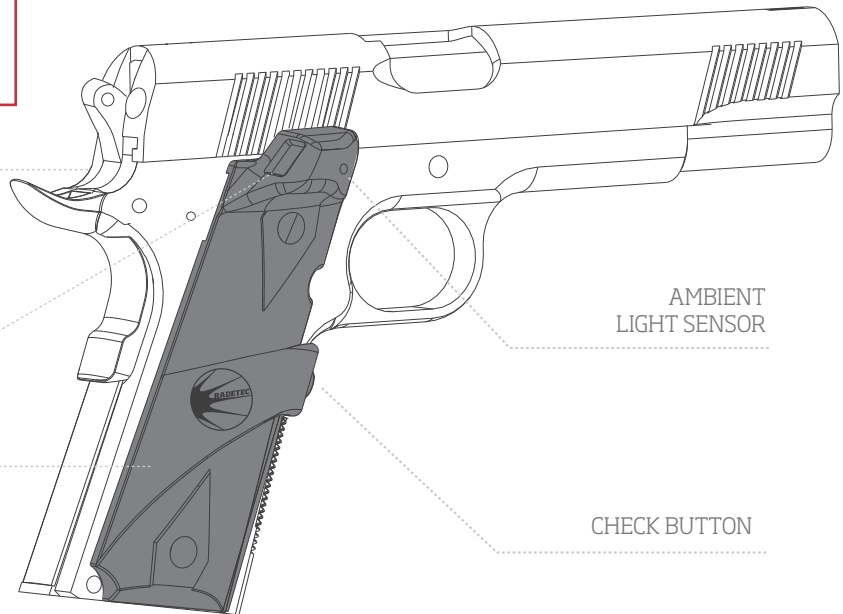

AMBIENT
LIGHT SENSOR

CHECK BUTTON

DISPLAY ACTIVATION EVENTS

ACTIVATION

- Firing the gun.
- Pressing the check button.
- Pressing counter button to show the total number of shots fired.

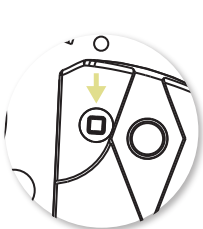

COUNTER BUTTON

Press this button on left side of the grip to show the accumulated number of shots fired.

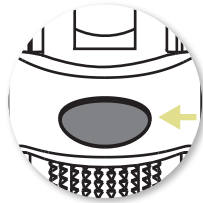

Push the check button to know the number* of cartridges in the magazine**.

Display intensity is automatically adjusted depending on ambient light.

DISPLAY EXAMPLE

WARNING

This device DOES NOT count rounds in the chamber and DOES NOT show if there is a round in the chamber. Always make sure your firearm is unloaded and with no round in the chamber.

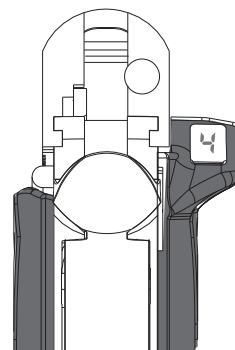

→ 42 SHOTS



Reset shot counter: push reset button.