

DIGITAL COUNTER

AR-15 / M-16

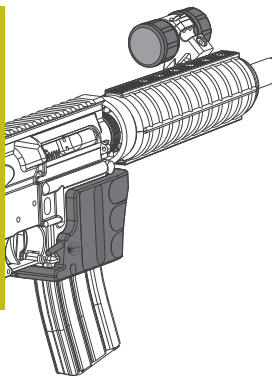

PACKAGE CONTENTS

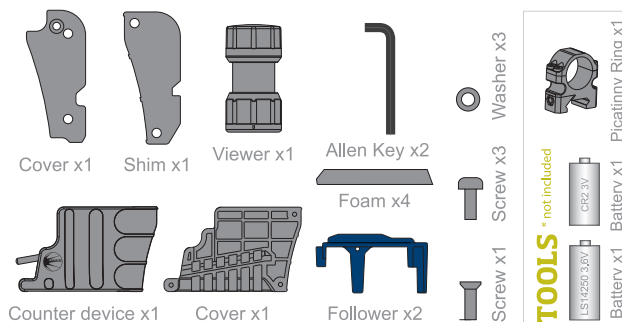

ASSEMBLY - RIFLE

Install the foams for better fit if necessary (depending on the model of the rifle)

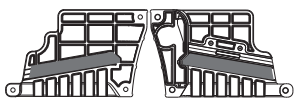

WARNING

Always make sure your firearm is unloaded, no rounds in the chamber and pointed in a safe direction before you disassemble and work on it.

Battery assembly for counter device

Do not cover for a correct device operation.

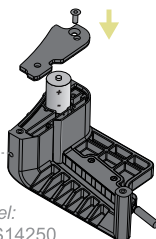

Battery model:
1/2 AA or LS14250

Attach DIGITALCOUNTER counter device to the lower receiver using screws and washers from the package

If necessary, install shim for better fit.

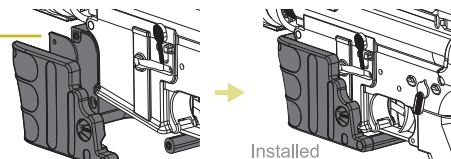

Installed

WARNING

This device DOES NOT count rounds in the chamber and DOES NOT show if there is a round in the chamber. Always make sure your firearm is unloaded and with no round in the chamber.

ASSEMBLY - RIFLE

Battery assembly for viewer

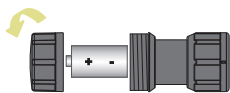

Battery model: CR2 3V

Attach viewer with a mounting ring(1") in a picatinny rail

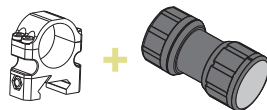

ASSEMBLY - MAGAZINE Use only USGI original magazines.

Disassemble the magazine and change the original follower

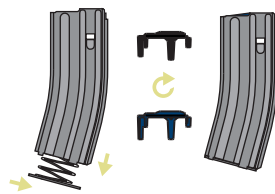

Supplied follower is compatible with lancer magazines. It may require device calibration.

ADDITIONAL DATA

- Never insert anything into the count sensor hole.
- Clean with water if it is dirty.
- Count error: 0,25%
- Initial total counts maybe different from zero. (Quality control)

CALIBRATION Use only USGI original magazines.

THE DEVICE HAS TWO DIFFERENT METHODS OF CALIBRATION

FIRST CALIBRATION:

1. SHOT COUNTER CALIBRATION

Put a cartridge in the magazine and shoot.
Push the button until the viewer shows a green LED.

NOTE: You can repeat this procedure as many times as necessary.

SECOND CALIBRATION:

COUNTER ROUNDS IN THE MAGAZINE CALIBRATION

1. MAGAZINE

Load 14 cartridges in the magazine.

2. RIFLE

Load a cartridge in the chamber. (13 in mag.)

Push the button until green LED turns on. (5 sec)

3. FIRE THE RIFLE

Shoot waiting 2 seconds between each shot. After each shot, the display will show the number of remaining cartridges. After the last shot, the green LED will turn on. (Calibration mode complete)

4. EXITING CALIBRATION MODE

Automatically after last shot. (Green LED).

5. RESET

To reset the device, you have to take out the battery of the counter device.

KNOW YOUR DIGITAL COUNTER

WARNING

Always make sure your firearm is unloaded, no rounds in the chamber and pointed in a safe direction before you disassemble and work on it.

VIEWER

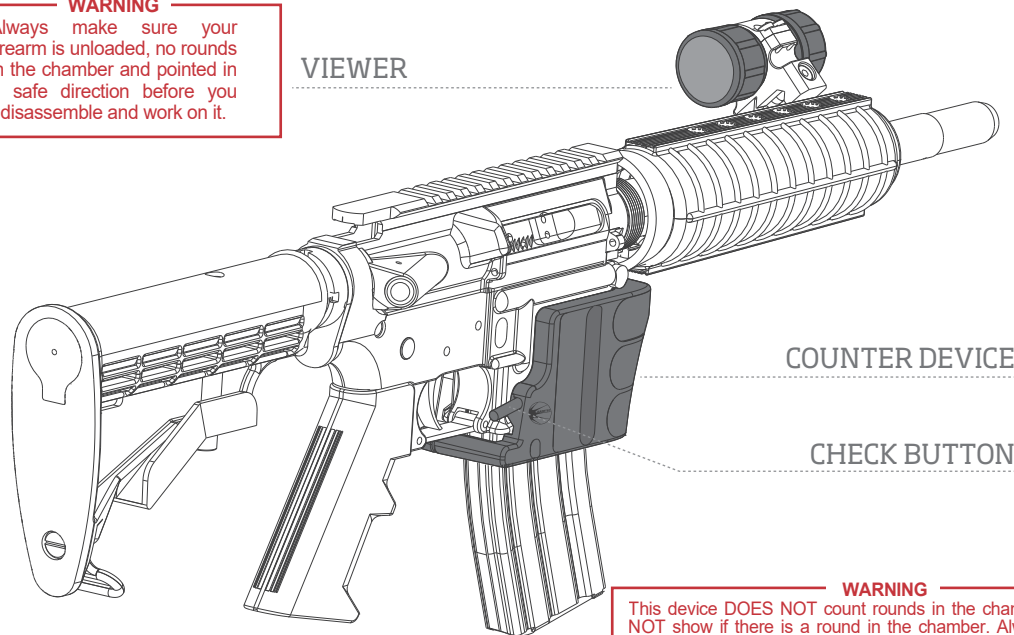

COUNTER DEVICE

CHECK BUTTON

WARNING

This device DOES NOT count rounds in the chamber and DOES NOT show if there is a round in the chamber. Always make sure your firearm is unloaded and with no round in the chamber.

DISPLAY ACTIVATION EVENTS

ACTIVATION

- Firing the rifle.
- Pressing the check button.
- Pressing check button during 3 seconds to show the total number of shots fired.

VIEWER: FIRING

Numbers **12 to 4 rd.**
 Continuous Red (Slow) **3 rd.**
 Continuous Red (Fast) **2 rd.**
 Blinking Red (Slow) **1 rd.**
 Blinking Red (Fast)** **0 rd.**

VIEWER: NO FIRING

Numbers **12 to 0 rd.**



BATTERY LEVEL

Blue LED indicates that the viewer's battery is low.

Battery model:
CR2 3V

Low battery counter device is indicated with:

LB

Battery model:
LS14250 3.6V

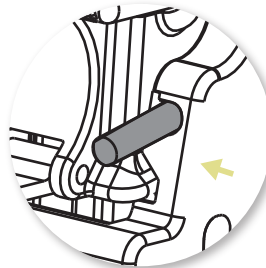

Push the check button to know the number** of cartridges in the magazine.

Display intensity is automatically adjusted depending on ambient light.

TOTAL FIRES VIEWER EXAMPLE

42 SHOTS



Tested on: Oberland / Sabre defence / Olympic Arms / Colt