

LED ADVISOR

BERETTA 92 FS



PACKAGE CONTENTS



LEDADVISOR x1

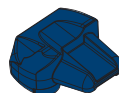

Follower x2



Plastic support x1

TOOLS

*not included



Screwdriver



CR 2016
Battery x1

ASSEMBLY · GUN

Disassemble the original grips

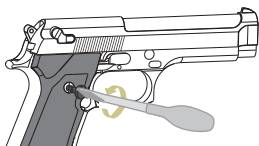

WARNING

Always make sure your firearm is unloaded, no rounds in the chamber and pointed in a safe direction before you disassemble and work on it.

Assemble the battery(RightGrip)

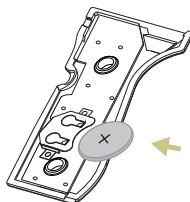

Assemble plastic support

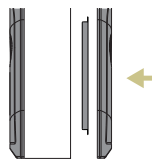

Put the plastic support between the gun and the right grip.

Assemble LEDADVISOR grips using original screws & washers



WARNING

This device DOES NOT count rounds in the chamber and DOES NOT show if there is a round in the chamber. Always make sure your firearm is unloaded and with no round in the chamber.

ASSEMBLY · MAGAZINE Use only Beretta original magazines.

Disassemble the magazine*

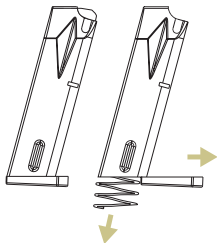

Remove the original follower

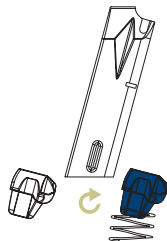

Replace it with the AMMOCONTROL follower

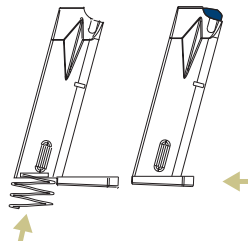

The system is ready to use



KNOW YOUR LED ADVISOR

LED INDICATOR

AMBIENT LIGHT SENSOR

CHECK BUTTON

GRIP

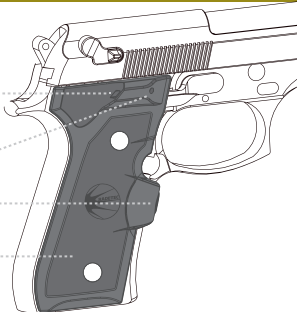

LED ACTIVATION EVENTS

Firing the gun or pressing the check button.

MONO-COLOUR 100-001

4+ rd. No Light
3 rd. Blinking Red (Slow)
2 rd. Blinking Red (Medium)
1 rd. Blinking Red (Fast)
0 rd. Continuous Red**

TRI-COLOUR 100-000

4+ rd. No Light
3 rd. Continuous Blue
2 rd. Continuous Green
1 rd. Continuous Red
0 rd. Blinking Red**



LED Intensity is automatically adjusted depending on ambient light.